

FD15

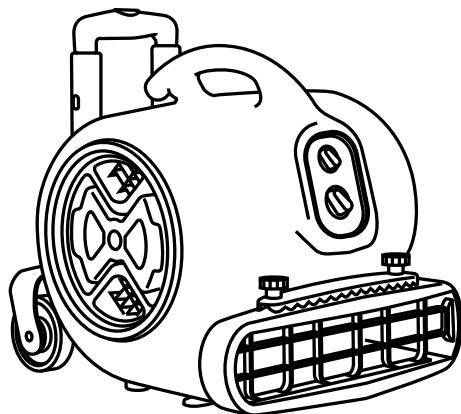

Air mover
Secador para moquetas
Aspirateur-sécheur

Use and maintenance manual
Manual de Uso y Mantenimiento
Manuel d'utilisation et d'entretien

HILLYARD
by HILLYARD

TRIDENT
by HILLYARD



Original instruction - DOC. 10073818- Ver. AA - 09-2017

<i>ENGLISH</i>	4
<i>ESPAÑOL</i>	14
<i>FRANÇAIS</i>	24

CONTENTS

PURPOSE AND CONTENT OF THE MANUAL	5
TARGET GROUP	5
STORING THE USE AND MAINTENANCE MANUAL	5
ON DELIVERY OF THE APPLIANCE	5
INTRODUCTORY COMMENT	5
IDENTIFICATION DATA	5
TECHNICAL DESCRIPTION	5
INTENDED USE	5
SAFETY	6
SERIAL NUMBER PLATE	6
TECHNICAL DATA	6
GENERAL SAFETY REGULATIONS	7
PREPARATION OF THE APPLIANCE	11
HANDLING THE PACKED APPLIANCE	11
HOW TO UNPACK THE APPLIANCE	11
HOW TO TRANSPORT THE APPLIANCE	11
COMPONENT POSITIONING	11
APPLIANCE SAFETY	12
PREPARING TO WORK	12
WORK	12
AT THE END OF THE WORK	13
MAINTENANCE	13
TROUBLESHOOTING	14
DISPOSAL	14

The descriptions contained in this document are not binding. The company therefore reserves the right to make any modifications at any time to elements, details, or accessory supply, as considered necessary for reasons of improvement or manufacturing/commercial requirements. The reproduction, even partial, of the text and drawings contained in this document is prohibited by law.

The company reserves the right to make any technical and/or supply modifications. The images are shown as a reference only, and are not binding as to the actual design and/or equipment.

SYMBOLS USED IN THE MANUAL



Open book symbol with an "i":
Indicates the need to consult the instruction manual.



Open book symbol:
Tells the operator to read the manual before using the appliance.



Covered place symbol:
The operations preceded by this symbol must always be carried out in a dry, covered area.



Warning symbol:
Carefully read the sections marked with this symbol and observe the indications, for the safety of the operator and the appliance.



Disposal symbol:
carefully read the sections marked with this symbol for disposing of the appliance.

PURPOSE AND CONTENT OF THE MANUAL

The aim of this manual is to provide customers with all the information needed to use the appliance in the safest, most appropriate and most autonomous way. It includes information concerning technical aspects, safety, operation, appliance downtime, maintenance, spare parts and scrapping. Operators and qualified technicians must read the instructions in this manual carefully before carrying out any operation on the appliance. If in doubt about the correct interpretation of instructions, contact your nearest Customer Service Centre to obtain the necessary clarifications.

TARGET GROUP

This manual is aimed at operators and qualified technicians responsible for appliance maintenance. Operators must not perform operations that should be carried out by qualified technicians. Hillyard cannot be held liable for damages resulting from failure to comply with this prohibition.

STORING THE USE AND MAINTENANCE MANUAL

The Use and Maintenance Manual must be stored in its special pouch close to the appliance, protected from liquids and anything else that could compromise its legibility.

ON DELIVERY OF THE APPLIANCE

When the machine is delivered to the customer, an immediate check must be performed to ensure all the material mentioned in the shipping documents has been received, in addition to verifying that the equipment has not been damaged during transportation. If this is the case, the carrier must ascertain the extent of the damage at once, informing our customer service office. It is only by prompt action of this type that the missing material can be obtained, and compensation for damage successfully claimed.

INTRODUCTORY COMMENT

Any type of equipment can only work properly and effectively if used correctly and kept in full working order by performing the maintenance operations described in the attached documentation. You should therefore read this instruction manual carefully, consulting it again if issues arise while using the machine. If necessary, remember that our assistance service (organised in collaboration with our dealers) is always available for advice or direct intervention.

IDENTIFICATION DATA

For technical assistance or to request replacement parts, always give the model, the version and serial number written on the serial number plate.

TECHNICAL DESCRIPTION

The **FD15** is an air mover device which, using a fan, creates a flow of air heated by an electric resistance inside it, and is capable of drying floors, carpets, etc. **The device should only be used for this purpose.**

INTENDED USE

This device is designed and intended for the drying of surfaces, in a commercial, public and industrial environments, in verified safety conditions and by a qualified operator.



The appliance is only suitable for use in indoor - or at least covered - areas. The device should not be used in the rain or under water jets. IT IS FORBIDDEN to use the appliance for picking up dangerous dusts or inflammable liquids in places with an explosive atmosphere. In addition, it is not suitable as a means of transport for objects.

SAFETY

Operator cooperation is paramount for accident prevention. No accident prevention programme can be effective without the full co-operation of the operator who is directly responsible for machine operation. The majority of occupational accidents that happen both in the workplace or whilst moving are caused by failure to respect the most basic safety rules. An attentive, careful operator is most effective guarantee against accidents and is fundamental in order to implement any prevention programme.

SERIAL NUMBER PLATE

The serial number plate is located on the rear part of the device, indicating its general characteristics (in particular, the serial number). The serial number is a very important piece of information and should always be provided together with any request for assistance or when purchasing spare parts.



TECHNICAL DATA	U/M	FD15
Power supply voltage	V	115
Frequency	Hz	60
Rated power	W	440
Air flow rate (max)	ft ³ /h	91,81
Head	Pa	600
Fan type		Radial
Fan speed	No.	3
Absorbtion	W	370 - 390 - 440
Air outlet dimensions	in	4,72 x 16,53
Air flow		blowing
Power supply cable	ft	32,81
Dimensions (length x width x height)	in	15,94 x 16,93 x 16,53
Weight	lb	22

GENERAL SAFETY REGULATIONS

The regulations below must be carefully followed in order to avoid harm to the operator and damage to the appliance.

WARNING:

- **Carefully read the warnings contained in this booklet and take care of it for further consultations.**
- Since the packaging elements (plastic bags, staples, etc.) are a source of danger they should not be left within the reach of children, disabled persons, etc.
- This appliance should only be used for the purpose for which it was constructed, namely: drying of inert, non-flammable and non-explosive surfaces. Any other use is considered incorrect and hence dangerous.
- When the appliance is operating do not bring it close to delicate organs like ears, mouth, eyes, etc.
- **This appliance should not be used by people (including children) with physical, sensory or mental disabilities, or by people with little experience or know-how, unless they have been controlled and instructed in the use of the appliance by people responsible for their safety. Children must be supervised to ensure they do not play with the appliance.**
- Carefully read the labels on the appliance. Do not cover them for any reason and replace them immediately if they become damaged.
- The appliance must be only used by authorised, trained personnel.
- The appliance is not suitable for use on rough or uneven floors. Do not use the appliance on slopes.
- It is necessary to make sure that the power supply cable do not suffer any damage caused by the vehicle wheels when moving, by crushing, tearing or the like. Protect the cable from heat, oil and sharp edges. Regularly check the power cable for any damage such as the formation of cracks, or ageing. If you notice any damage, the cable must be replaced before using the machine.
- In the event of danger, immediately remove the plug from the mains socket.
- For maintenance work, switch off the appliance using the main switch and remove the power cable plug from the main switch.

- When using the appliance, pay attention to other people and especially to children.
- When the appliance is not being used, it should not be left connected to the mains power supply. Before doing any maintenance work on the appliance pull out the plug from the mains. Do not immerse the appliance in water, do not use solvents.
- The manufacturer cannot be held liable for any damage to persons, animal or objects deriving from improper and unreasonable use, and in any event not complying with the instructions mentioned above.
- For scrapping, follow the regulations in force in the country.
- Do not use the appliance with the power cable twisted around the handle.
- The device must be powered by an isolation transformer or by a differential switch with a maximum differential current not exceeding 30mA..
- Before connecting the appliance to the electricity socket, make sure the electrical information on the plate corresponds to that of the mains supply.
- The appliance must only be powered with a voltage equal to that shown on the serial number plate.
- To avoid electric shock, do not use the appliance in standing water. Never plug or unplug the unit with wet hands or while standing in water.
- Do not move or carry the machine while it is running.
- Use only with GFCI protected receptacles. Please contact a qualified electrician for verification and / or installation of a GFCI receptacle if necessary.
- Do not operate any unit with a damaged cord or plug. Discard fan or return to an authorized service facility for examination and/or repair.
- It's automatically operated device. To reduce the risk of injury, disconnect from power supply before servicing.

WARNING:

- The appliance must not be used or kept outdoors, in damp conditions or directly exposed to rain.

- The storage temperature must be between -13°F and +131°F.
- Conditions of use: room temperature between 32°F and 104°F, with relative humidity between 30% and 95%.
- The power supply cable outlet must have an earth connection in compliance with the regulatory standards.
- The appliance does not cause harmful vibrations.
- Never use the appliance in environments with gas, liquids or explosive or inflammable powders, nor non-diluted acids and solvents! These include gasoline, paint thinners and fuel oil (which, when mixed with the vacuum air, can form explosive vapours or mixtures), and also non-diluted acids and solvents, acetones, aluminium and magnesium powders. These substances may also corrode the materials used to construct the appliance.
- If the appliance is used in dangerous areas (for example, gas stations), the relative safety standards should be observed. The appliance must never be used in environments with a potentially explosive atmosphere.
- Do not place any liquid containers on the appliance.
- In the event of a fire, use a powder extinguisher. Do not use water.
- If the appliance does not work properly, check this is not caused by failure to carry out routine maintenance. Otherwise, ask for intervention of the authorised technical assistance centre.
- If you need to replace any components, request the ORIGINAL spare parts from an Authorised dealer and/or Retailer.
- Restore all electrical connections after any maintenance interventions.
- Before using the appliance, check that all the hatches and covers are positioned as shown in this Use and Maintenance Manual. Do not remove the guards that can only be removed with the aid of tools, except for maintenance work (see the relevant paragraphs).
- Do not wash the appliance with direct water jets or with pressurised water, nor with corrosive substances.
- Have the appliance checked by an authorised technical assistance centre every year.
- When disposing of the appliance, comply with currently effective laws and regulations.
- When, after years of valuable work, your appliance needs to be

finally decommissioned, dispose of the materials contained within it appropriately, bearing in mind that the appliance is made of fully recyclable materials.

- **WARNING: To Reduce This Risk Of Fire Or Electric Shock, Do Not Use Unit With Any Solid-State Speed Control Device.**
- Do not run cord under carpeting. Do not cover cord with throw rugs, runners, or similar coverings. Do not route cord under furniture or appliances. Arrange cord away from traffic area and where it will not be tripped over.

PREPARATION OF THE APPLIANCE

HANDLING THE PACKED APPLIANCE

The appliance is delivered in specific packaging. These packaging elements (plastic bags, clips, etc.) are potential sources of danger are potential sources of danger and must be kept out of the reach of children, incompetent persons, etc. The overall weight of the appliance plus its packaging is 12 kg. The dimensions of the package are as follows:

- A : 18,31in
- B : 17,72in
- C : 17,12in

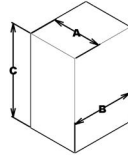

HOW TO UNPACK THE APPLIANCE

The procedure for removing the device from its packaging is the following:

1. Open the outer box.
2. Remove the cardboard retainer.
3. Take the appliance out of the box.
4. Take the appliance out of the protective bag.

- ATTENTION:** *it is recommended that all the packaging components be kept for any future transportation of the appliance.*
- ATTENTION:** *Users are advised to always wear protective gloves, to avoid the risk of serious injury to hands.*
- ATTENTION:** *Since the packaging elements (plastic bags, staples, etc.) are a source of danger they should not be left within the reach of children, disabled persons, etc.*

HOW TO TRANSPORT THE APPLIANCE

The procedure for the safe handling of the device is the following:

1. Take all necessary steps to ensure that the device is in a safe condition (read the section "MACHINE SAFETY").
2. Insert the appliance into the protective bag, taking care not to damage either during this operation.
3. Insert the appliance into the carton, taking care not to damage either during this operation.
Remember to place the lower cardboard retainer at the bottom of the box.

4. Insert the upper cardboard retainer.
5. Close the carton.

- ATTENTION:** *When transporting the appliance on vehicles, secure it according to the directives in force so that it cannot slide or tip over.*
- ATTENTION:** *Users are advised to always wear protective gloves, to avoid the risk of serious injury to hands.*

COMPONENT POSITIONING

The control panel components are identified as follows:

1. Lifting handle.
2. Housing for winding the power cable.
3. Shut-down timer knob.
4. Three-speed main switch knob.
5. Retainer blade knob.
6. Retainer blade.
7. Air outlet nozzle.
8. Air inlet nozzle.
9. Trolley handle button.
10. Trolley handle.
11. Transport wheels.
12. Support lever.
13. Power cable.
14. Power cable fastener.

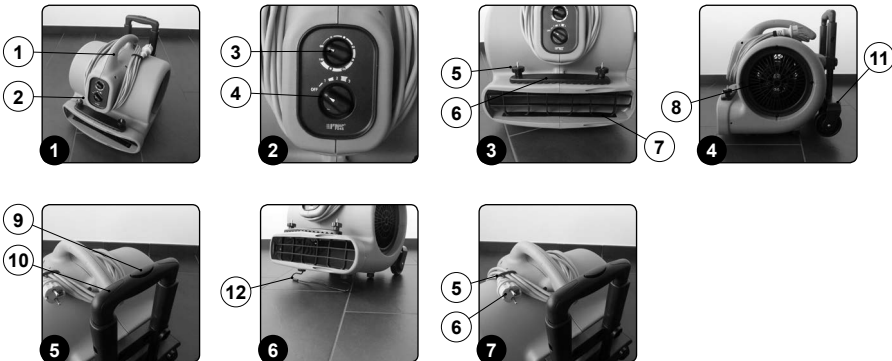

APPLIANCE SAFETY

The stages for making the appliance safe, thereby making it possible to carry out operations safely, are as follows:

1. Check that the main switch (1) is in the "OFF" position, otherwise turn it anticlockwise as far as it will go.
2. Check that the plug (2) on the power cable (3) has been taken out of the socket (4) of the mains supply, and if not, disconnect it.

3. Wind the power cable under the appliance's lifting handle and secure it with the clip (5).



ATTENTION: Users are advised to always wear protective gloves, to avoid the risk of serious injury to hands.



ATTENTION: To prevent damaging the power cable, disconnect the plug from the mains socket by directly pulling the plug and not the cable.

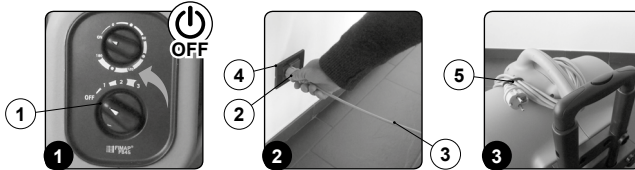

PREPARING TO WORK

Before beginning to work, it is necessary to:

1. Before using, the appliance must be in order and safe to use with the work equipment, especially the power cable. If everything is not in order, the appliance must not be used.

2. Make sure that there is no dirt in the air inlet nozzles (1) (Fig.1).
3. Make sure that there is no dirt in the air outlet nozzles (2) (Fig.2).
4. Make sure the power supply cable is not damaged.

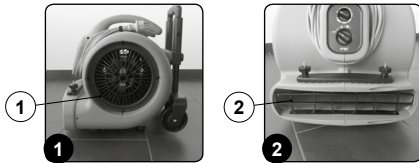

WORK

To start working, proceed as follows:

1. Make all the checks listed in "PREPARING TO WORK".
2. Place the appliance in the position most agreeable to the type of work to be carried out.

Fig.1 horizontal position, the air outlet nozzle is perpendicular to the floor.

Fig.2 tilted position, the air outlet nozzle is inclined upward in relation to the floor, using lever (1) as a support base

Fig.3 vertical position, the air outlet nozzle is parallel to the floor.

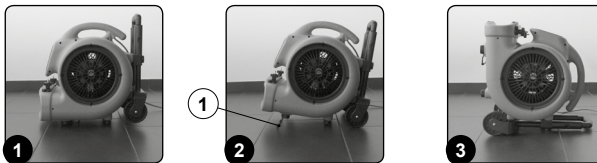

3. Insert the plug (2) of the power supply cable (3) in the mains socket (4) (Fig.1).

4. Turn on the appliance by pressing the main switch (5) (Fig.5).

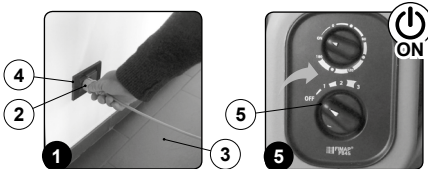

The appliance has three operating speeds; to select one of these speeds turn the switch (5) clockwise (Fig.6).

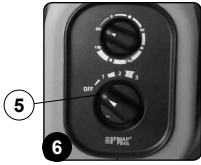

The appliance is equipped with an operating timer; to select the operating time, simply turn the knob (6) clockwise (Fig.7). As soon as the knob is released on the chosen time, the operating timer will start, and will stop when it arrives to position "0".

! ATTENTION: By positioning the knob to ON, the timing function is not in operation.

! ATTENTION: It can be set from a minimum of 30 minutes up to a maximum of 180 minutes.

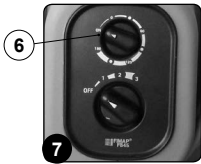

If the air has to be blown under a carpet, proceed as follows:

1. Turn the knobs (7) anti-clockwise (Fig.8).
2. Insert the carpet beneath the blade (8) (Fig.9).

3. Fasten the carpet to the appliance by turning the knobs (7) clockwise.

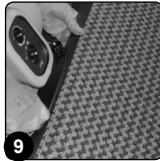

AT THE END OF THE WORK

At the end of the work, and before carrying out any type of maintenance, perform the following operations:

1. Take all necessary steps to ensure that the device is in a safe condition (read the section "MACHINE SAFETY").
2. Take the appliance to the designated storage area.

! ATTENTION: Park the appliance in an enclosed place, on a flat surface; near the appliance there must be no objects that could either damage it, or be damaged through contact with it.

MAINTENANCE

At the end of the work proceed as follows:

1. Take all necessary steps to ensure that the device is in a safe condition (read the section "MACHINE SAFETY").
2. Take the device to the dedicated maintenance area.
3. With the aid of a vacuum cleaner, remove impurities present in

the air inlet nozzles (1) (Fig.1).

4. With the aid of a vacuum cleaner, remove impurities present in the air inlet nozzles (2) (Fig.2).
5. With the aid of a damp cloth, clean the outside surfaces of the appliance (Fig.3).

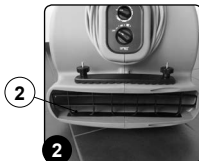
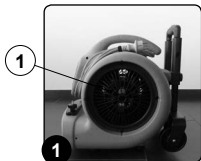

TROUBLESHOOTING

This chapter lists the most common problems linked with the use of the appliance. If you are unable to resolve the problems with the information given here, please contact your nearest assistance centre.

PROBLEM	POSSIBLE CAUSE	SOLUTION
The appliance doesn't work	The power cable is not connected to the mains socket.	Connect the plug of the power cable to the mains socket.
	The main switch is in the "OFF" position.	Turn the main switch clockwise and select one of the three operating speeds.
	The fan is blocked.	Remove the obstruction blocking the rotation of the fan.
	The air inlet or outlet nozzle is blocked.	Remove the obstruction blocking the nozzle.
The appliance vibrates.	Residues on the fan.	Remove the residues on the fan.

DISPOSAL

To dispose of the appliance, take it to a demolition centre or an authorised collection centre.

Before scrapping the machine, it is necessary to remove and separate out the following materials, then send them to the appropriate collection centres in accordance with the environmental hygiene regulations currently in force:

- Felt
- Electric and electronic parts*
- Plastic parts
- Metallic parts

(*) In particular, contact your local distributor when scrapping electric and electronic parts.

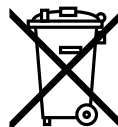

Manufacturer:

FIMAP S.p.A.

Via Invalidi del Lavoro, n°1
 c.a.p. 37059 - S. Maria di Zevio (VR) - Verona - Italia
 Tel. +39 045 6060411 - Fax. +39 045 6060417
 E-mail: fimap@fimap.com
 Web: www.fimap.com

Agent:

Hillyard, Inc.

302 North 4th Street - P.O. Box 909 - St. Joseph, Missouri
 64501 USA
 Phone: 1-800-365-1555 - Fax: 1-800-881-3840
 Web: www.hillyard.com



HILLYARD INDUSTRIES - PO Box 909 - St. Joseph, Missouri 64502-0909 U.S.A. - Telephone: 816-233-1321 - www.hillyard.com